

# HEC MILLING CHUCK (AM TYPE)

HEC 精銑夾頭刀柄 (AM型)

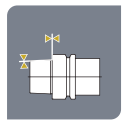

Dual face contact  
兩面接觸

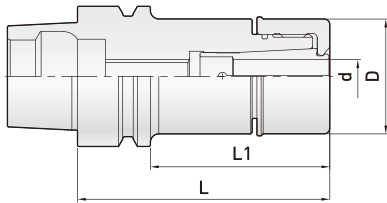

Surface roughness  
表面粗度

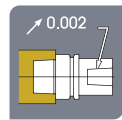

Run out accuracy  
內孔偏擺度



Surface hardness  
表面硬度

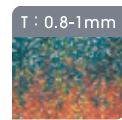

Carbonized depth  
滲碳深度

Order Code 訂購編號	Range(d) 夾持範圍	L	L1	D	Min <sup>-1</sup> G2.5 動態平衡	Nut 螺帽	Spanner 板手
HSK40E-HEC8-70AM	3~8	70	50	30	42,000	CN-HEC8AM	30194-830
HEC12-75AM	4~12	75	55	42	42,000	CN-HEC12AM	30194-842
HSK50E-HEC8-70AM	3~8	70	44	30	36,000	CN-HEC8AM	30194-830
HEC12-70AM	4~12	70	44	42	36,000	CN-HEC12AM	30194-842

- The circular nuts can be replaced with the hexagonal nuts.
- Clamping nut design by circular cylinder. Bearing spanner must be used.
- End mill chuck specially designed for hard cutting material.
- Superior surface finish for mold tools and 3-D work.
- Bearing spanner and stop screw must be ordered separately.

- 全圓螺帽可以換成六角螺帽。
- 全圓螺帽，必須使用軸承扳手。
- 專門為難切削材設計的銑刀夾頭。
- 在模具加工時，表面光潔度極佳。
- 軸承扳手及止動螺絲必須另外訂購。



# HEC COLLET

HEC 筒夾

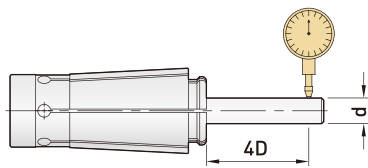

- Runout <math>< 5\mu\text{m}</math> [ 4×D ]
- 跳動精度 <math>< 5\mu\text{m}</math> [ 4×D ]

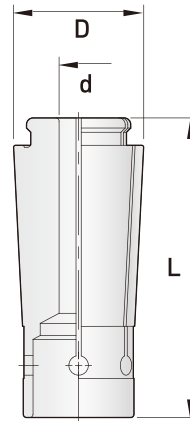

Order Code 訂購編號	d	(d) 持夾徑	L	D
HEC8-3	3	3	35	16
4	4	4		
5	5	5		
6	6	6		
8	8	8		
HEC12-4	4	4	46	20
6	6	6		
8	8	8		
10	10	10		
12	12	12		

## HEC NUT (AC TYPE)

HEC 螺帽 (AC型)



Order Code 訂購編號	Outside Dia 外徑	Collet 筒夾規格
CN-HEC8AC	30	HEC8
HEC12AC	42	HEC12

## HEC NUT (AM TYPE)

HEC 螺帽 (AM型)



Order Code 訂購編號	Outside Dia 外徑	Collet 筒夾規格
CN-HEC8AM	30	HEC8
HEC12AM	42	HEC12

## SPANNER

扳手



Order Code 訂購編號	Type 型式
30194-724	SP-HEC8
702	SP-HEC12



Order Code 訂購編號	Nut 螺帽規格	inside Dia 內徑
30194-830	CN-HEC8AM	30
842	CN-HEC12AM	42